



TAYLOR'S
UNIVERSITY

Wisdom • Integrity • Excellence

ORIENTATION

August 2023

*Intensive English (IEN)
Diploma in Hotel Management / Culinary Arts
Advanced Diploma in Patisserie & Gastronomic Cuisine
American Degree Transfer Program
Postgraduate Taught Programmes*

Welcome to Taylor's Lakeside Campus



**VICE CHANCELLOR &
PRESIDENT**

As a new member of Malaysia's top private university you will have access to world class teaching and learning facilities. The Lakeside Campus is the most iconic University Campus in Malaysia and has been ranked as the top university campus in Malaysia by international students. I would encourage you to make the most of what we have available for you here on campus.

In joining Taylor's University you are becoming part of a large multi-ethnic and multi-national community of scholars. This will provide you with the unique opportunity to study alongside the brightest students in Malaysia and from around the world, and to make friendships that will endure for the rest of your life.

May I encourage you to make the most of the unique experiences that we offer at Taylor's University and if you have come from outside Kuala Lumpur or Malaysia, to enjoy the cultural and leisure opportunities offered by the city and the country.

I am delighted that you have chosen Taylor's University for your higher education. I wish you every success in your studies and every enjoyment during your time with us.

Very best wishes,
Michael Driscoll

Welcome to Taylor's Lakeside Campus

CONTENTS

Arriving at Taylor's Lakeside Campus	3
Commuting to Taylor's Lakeside Campus	4 – 12
Orientation Programme	13
Orientation FAQ	14
Taylor's University Student Council	15 – 16
Campus Floor Plan	17 – 18

Arriving at Taylor's Lakeside Campus



1. STUDENT ID

It is very important to have your Student ID with you and displayed at all times when you are on campus. To obtain your student ID card, you must first upload your photo. Please refer to [Campus Central Portal](#) on how to do this.

2. PEDESTRIAN GATE ACCESS

If you are staying in PJ57/PJ59 area, or taking public transportation (ie. the RapidKL Bus 783 or BRT) to/from campus, you may access the pedestrian gate using your Student ID card. The gate is open from 6am to 1am daily.

3. PARKING SYSTEM IN LAKESIDE

Free parking bays are available at Zone H and Zone I in Lakeside Campus. Parking fee of RM3 per entry is applicable to Zone J and basement parking at the Boardwalk. The parking facility is on a first-come, first-served basis. Please look for alternative sites if all the parking bays are taken up.

4. COMMUTING TO LAKESIDE CAMPUS

The means of public transportation available for commuting to Taylor's Lakeside Campus are detailed in the pages listed below.

Transportation guide – Refer to page 4, 5 & 6

Shuttle bus schedule – Refer to page 7 - 12

5. DRESS CODE POLICY

Students must dress neatly with clean attire at all times. Students are advised to be mindful of the cultural sensitivities of others and the academic environment.

6. SMOKE-FREE CAMPUS ENVIRONMENT

Smoking is not permitted on Taylor's campus grounds. The Syopz Mall is also a smoke-free mall except for the designated smoking area located at LG2 (in front of Happy Wash). Students found smoking on campus grounds will face the below consequences:

First-time offenders will be given a verbal warning and their details will be recorded in a database by Student Welfare Department.

For a second offence, the student will be fined RM50 and receive a warning letter from the University.

If a third offence is committed, the student will be fined RM100 and be subjected to disciplinary action.

Commuting to Taylor's Lakeside Campus

Students may commute to Taylor's Lakeside Campus using public transportation such as BRT Sunway Line (SunMed Station), KTM Komuter (Sentul – Port Klang Line), LRT (Kelana Jaya Line), Rapid KL 783 bus (from Kelana Jaya), or using the Taylor's shuttle buses.



BUS RAPID TRANSIT (BRT) ●

Alight at BRT SunMed station and use the pedestrian bridge (800m walk) to the campus pedestrian gate.

(Please refer to the Klang Valley Integrated Rail System for the complete rail system)



KTM KOMUTER ●

Alight at Setia Jaya Station or Subang Jaya Station and take our Taylor's shuttle bus to Lakeside campus.

(Please refer to the shuttle bus schedule for the pick-up location & time)



TAYLOR'S SHUTTLE BUS ●

The shuttle buses cover the following pick-up points;

- SS15 bus stop (in front of Maybank)
- SuriaMas / Ridzuan Apartment
- Subang Jaya KTM Station
- Setia Jaya KTM Station
- SS15 LRT Station bus stop
- Behind E-Tiara Apartment (morning)
- Bus stop in front of Aeon Big (afternoon)
- Sunway Pyramid bus stop
- Mentari Court / Leisure Commerce Square

(Please refer to the shuttle bus schedule for the pick-up time)



LIGHT RAIL ● TRANSIT (LRT)

Alight at SS15 LRT station and take the Taylor's shuttle bus to Lakeside campus.

(Please refer to the shuttle bus schedule for the pick-up time)



RAPID KL 783 BUS ●

This bus runs from the Kelana Jaya LRT Station to Sunway area via the LDP.

You should alight at the bus stop at Jalan PJS 7/8, PJS7 and take a 5-min walk to the campus pedestrian gate. To return to Kelana Jaya, the bus will run pass Subang Jaya before heading back to Kelana Jaya LRT station via Federal Highway.

(Please refer to the bus route for RapidKL 783 in the next page)

Note :

For those taking RapidKL 783 Bus or BRT, you need a pedestrian gate access to enter the Campus. Please refer to page 3 (Arriving at Taylor's Lakeside Campus), point no. 2 for details.

Map & Bus Route to Taylor's Lakeside Campus

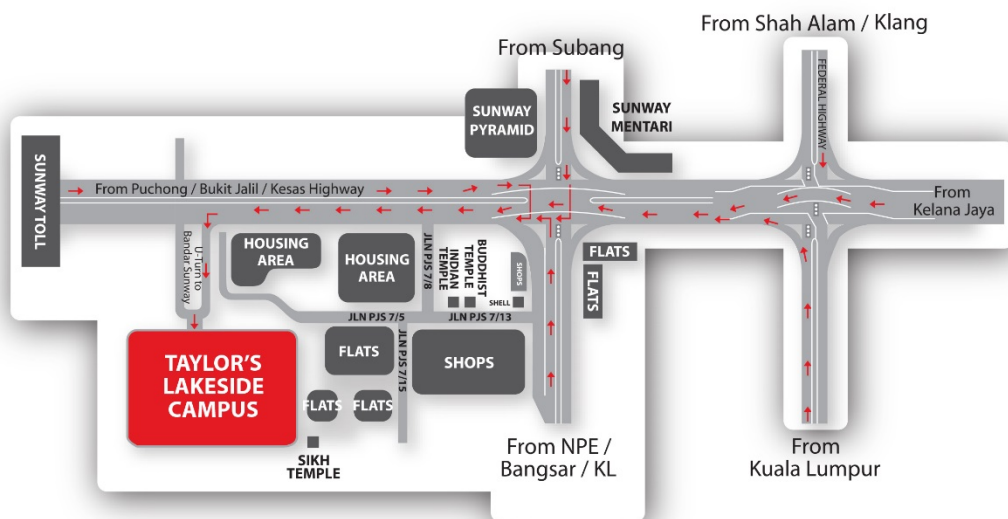

GPS Coordinate : N3° 3.886'
E101° 36.995'



RAPIDKL 783 (Bus Route):

Stesen LRT Kelana Jaya to Sunway & Subang Parade

Stesen LRT Kelana Jaya

- ✓ Stesen LRT Kelana Jaya, LDP
- ✓ SMK Kelana Jaya, LDP
- ✓ Pos Malaysia, LDP
- ✓ Bus Stop @ PJS 7, Jalan PJS 7/8
- ✓ Tokong Cina, Jalan PJS 7/13
- ✓ Carry Boy, Jalan PJS 7/13
- ✓ Sunway Pyramid, Lebuhraya NPE
- ✓ Sekolah Sri KL, Persiaran Kewajipan
- ✓ SJMC (opp), Persiaran Kewajipan

- ✓ Stesen LRT Kelana Jaya, LDP
- ✓ Simpang Jalan SS 2/3
- ✓ Stesen LRT Kelana Jaya 7-11, LDP
- ✓ KJMC, LDP
- ✓ Giant Kelana Jaya (opp), LDP
- ✓ Western Digital, LDP
- ✓ Nanyang Siang Pau, Lebuhraya Persekutuan
- ✓ Seksyen 19, Persiaran Subang Kemajuan
- ✓ ESSO / SHELL
- ✓ Subang Parade (opp), Persiaran Kemajuan Subang

Alight here to
Taylor's Lakeside
Campus

Sunway / Subang Parade

- ✓ Hotel Park, Persiaran Kemajuan Subang
- ✓ Aeon Big

First Bus : 6.00am
Last Bus : 11.30pm

Klang Valley Integrated Rail System

Scan here to
download the
map

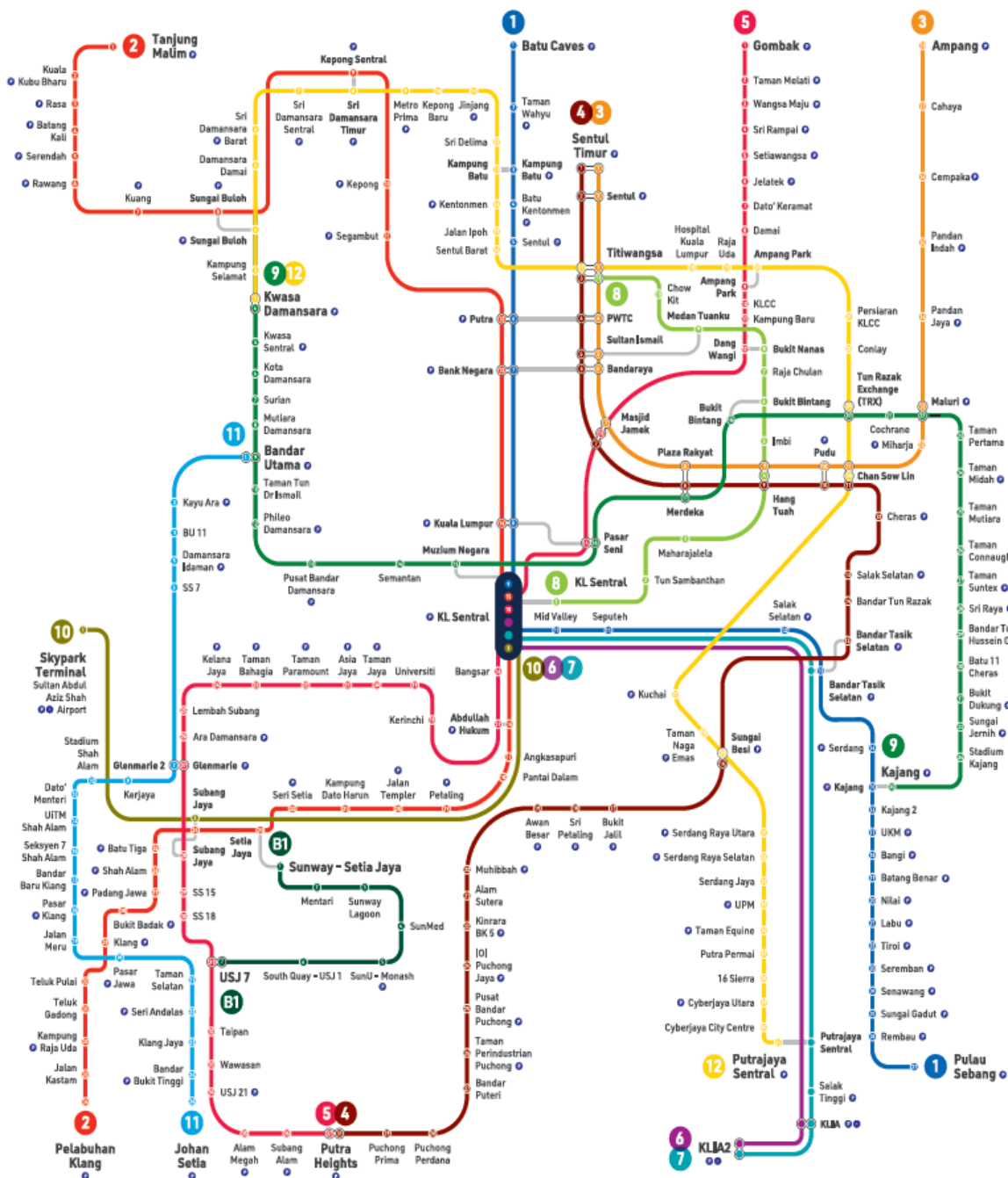

1 KTM Larian Batu Caves - Pulau Sebang
 2 KTM Batu Caves - Pulau Sebang Line
 3 KTM Larian Tanjung Malim - Pelabuhan Klang
 4 KTM Tanjung Malim - Pelabuhan Klang Line
 5 LRT Larian Ampang
 6 LRT Ampang Line
 7 LRT Larian Kelana Jaya
 8 LRT Kelana Jaya Line
 9 LRT Larian KLIA Transit
 10 LRT Larian KLIA Transit Line
 11 MRT Larian Klang
 12 KTM Larian KL Sentral - Skypark Terminal
 13 KTM KL Sentral - Terminal Skypark Line
 14 LRT Larian Shah Alam (Akan Ditempa)
 15 LRT Shah Alam Line (Akan Ditempa)
 16 MRT Larian Putrajaya
 17 MRT Putrajaya Line
 18 BRT Sunway Line
 19 BRT Sunway Line
 20 Tempang Larian Kenderaan
 21 Tempang Larian Kenderaan
 22 Terminal Lapangan Terbang
 23 Airport

Shuttle Bus Schedule

The following bus schedule is effective from **Tuesday, 7 February 2023.**

Shuttle bus services are NOT AVAILABLE on Public Holidays & Replacement Public Holidays. Please adhere to the guidelines and obey instructions provided by the bus operator.

BUS FARE:

RM 1.50 per trip (Cashless payment by Touch 'n Go card with a minimum credit of RM5.00. Please purchase the Touch 'n Go card from the driver if you don't have it. The card price is RM30.00 with a credit of RM10.00). Touch 'n Go reload service is not provided by the shuttle bus operator.

TAYLOR'S SHUTTLE BUS TRACKER:

Please download **"EUP-GPS (Malaysia)"** from Play Store or Apple Store and fill the details as follows:-

Company : Taylor
Username : Passenger
Password : 1234



REEL SHARED ON 21 AUGUST 2020
BY PGSC TAYLORS

MONDAY - FRIDAY

Morning

Route TU1A

Bus stop opposite Mentari Court and LCS (can be access from KTM Setia Jaya)	Aman / Suria Mas / Ridzuan Apt	Caltex opposite Sunway Pyramid (near pedestrian bridge)	DK Senza	Lakeside Campus
7.00am , 7.30am	Drop-off / Pickup	Drop-off / Pickup	Drop-off / Pickup	Back to LCS / Mentari Court
8.00am , 8.30am	Drop-off / Pickup	Drop-off / Pickup	Drop-off / Pickup	Back to LCS / Mentari Court
9.00am , 9.30am	Drop-off / Pickup	Drop-off / Pickup	Drop-off / Pickup	Back to LCS / Mentari Court
10.00am , 10.30am	Drop-off / Pickup	Drop-off / Pickup	Drop-off / Pickup	Back to LCS / Mentari Court
11.00am , 11.30am	Drop-off / Pickup	Drop-off / Pickup	Drop-off / Pickup	Back to LCS / Mentari Court
12.00pm	Drop-off / Pickup	Drop-off / Pickup	Drop-off / Pickup	Back to LCS / Mentari Court
12.30pm	Drop-off / Pickup	Drop-off / Pickup	Drop-off / Pickup	Drop-off (Trip ends)

Route TU2A

KTM Subang Jaya Bus Stop	E-Tiara / Behind Aeon Big	SS15 LRT Station Gate B Bus Stop	Bus stop at SS15 Maybank / RHB	Caltex opposite Sunway Pyramid (near pedestrian bridge)	Lakeside Campus
7.00am, 7.30am	Drop-off / Pickup	Drop-off / Pickup	Drop-off / Pickup	Drop-off / Pickup	Back to E-Tiara
8.00am , 8.30am	Drop-off / Pickup	Drop-off / Pickup	Drop-off / Pickup	Drop-off / Pickup	Back to E-Tiara
9.00am , 9.30am	Drop-off / Pickup	Drop-off / Pickup	Drop-off / Pickup	Drop-off / Pickup	Back to E-Tiara
10.00am , 10.30am	Drop-off / Pickup	Drop-off / Pickup	Drop-off / Pickup	Drop-off / Pickup	Back to E-Tiara
11.00am , 11.30am	Drop-off / Pickup	Drop-off / Pickup	Drop-off / Pickup	Drop-off / Pickup	Back to E-Tiara
12.00pm	Drop-off / Pickup	Drop-off / Pickup	Drop-off / Pickup	Drop-off / Pickup	Back to E-Tiara
12.30pm	Drop-off / Pickup	Drop-off / Pickup	Drop-off / Pickup	Drop-off / Pickup	Drop-off (Trip ends)

Shuttle Bus Schedule

TU1A



Bus stop opposite
Mentari Court and
LCS (can be access
from KTM Setia
Jaya)



Aman / Suria Mas /
Ridzuan Apt



Caltex opposite
Sunway Pyramid
(near pedestrian
bridge)



DK Senza



Block B, bus stop,
Lakeside Campus

TU2A



KTM Subang Jaya
bus stop



Behind E-tiara



SS15 LRT Station
Gate B Bus Stop



Bus stop at SS15
Maybank / RHB



Caltex opposite
Sunway
Pyramid (near
pedestrian
bridge)



Block B, bus stop,
Lakeside Campus

Shuttle Bus Schedule

MONDAY - FRIDAY

Afternoon / Night

Route TU1C

<u>Lakeside Campus</u>	<u>Sunway Pyramid (new wing bus stop)</u>	<u>Aman / Ridzuan Apt / Suria Mas</u>	<u>**DK Senza</u>
1.00pm	Drop-off / Pickup	Drop-off / Pickup	Back to Campus
2.15pm , 2.45pm	Drop-off / Pickup	Drop-off / Pickup	Back to Campus
3.15pm , 3.45pm	Drop-off / Pickup	Drop-off / Pickup	Back to Campus
4.15pm , 4.45pm	Drop-off / Pickup	Drop-off / Pickup	Back to Campus
5.15pm	Drop-off / Pickup	Drop-off / Pickup	Back to Campus
6.15pm	Drop-off / Pickup	Drop-off / Pickup	Back to Campus
7.15pm	Drop-off / Pickup	Drop-off / Pickup	Back to Campus
8.15pm , 8.45pm	Drop-off / Pickup	Drop-off / Pickup	Back to Campus
9.15pm , 9.45pm	Drop-off / Pickup	Drop-off / Pickup	Back to Campus
*10.15pm	Drop-off / Pickup	Drop-off / Pickup	Back to Campus (Trip ends)

Route TU2B

<u>Lakeside Campus</u>	<u>Bus stop at KTM Setia Jaya (Federal Highway side)</u>	<u>Bus stop opposite E-Tiara, Aeon Big and Subang Parade</u>	<u>SS15 LRT Station Gate B Bus Stop</u>	<u>Bus stop at SS15 Maybank / RHB, Caltex opposite Sunway Pyramid (near pedestrian bridge) / **DK Senza</u>
1.00pm	Drop-off / Pickup	Drop-off / Pickup	Drop-off / Pickup	Back to Campus
2.15pm , 2.45pm	Drop-off / Pickup	Drop-off / Pickup	Drop-off / Pickup	Back to Campus
3.15pm , 3.45pm	Drop-off / Pickup	Drop-off / Pickup	Drop-off / Pickup	Back to Campus
4.15pm , 4.45pm	Drop-off / Pickup	Drop-off / Pickup	Drop-off / Pickup	Back to Campus
5.15pm , 5.45pm	Drop-off / Pickup	Drop-off / Pickup	Drop-off / Pickup	Back to Campus
6.15pm , 6.45pm	Drop-off / Pickup	Drop-off / Pickup	Drop-off / Pickup	Back to Campus
7.15pm , 7.45pm	Drop-off / Pickup	Drop-off / Pickup	Drop-off / Pickup	Back to Campus
8.15pm , 8.45pm	Drop-off / Pickup	Drop-off / Pickup	Drop-off / Pickup	Back to Campus
9.15pm , 9.45pm	Drop-off / Pickup	Drop-off / Pickup	Drop-off / Pickup	Back to Campus
*10.15pm	Drop-off / Pickup	Drop-off / Pickup	Drop-off / Pickup	Back to Campus (Trip ends)

* Last trip from Taylor's Lakeside Campus at 10.15pm

** Buses will not stop at DK Senza if the traffic within campus is too congested

Students are advised to be at the bus stop at least 10 minutes before the departure time. If you have any concerns about the shuttle services or experience delays, please contact the bus supervisor at **016-787 3173 (Mr. Peter)** or email to CampusCentral@taylors.edu.my. Please take note that the arrival and departure times are only indicative and may vary due to traffic condition. Bus schedule may be changed without prior notice due to heavy traffic or weather condition.

Shuttle Bus Schedule

TU1C



Block B, bus stop,
Lakeside Campus



Sunway Pyramid
(new wing bus stop)



Aman / Suria Mas /
Ridzuan Apt



DK Senza



Block B, bus stop,
Lakeside Campus



Bus stop at KTM Setia
Jaya (Federal Highway
side)



Bus stop
opposite E-Tiara
& Aeon Big



Bus stop at SS15
Maybank / RHB



SS15 LRT Station
Gate B Bus Stop



Bus stop opposite
Subang Parade



Caltex opposite
Sunway Pyramid
(near pedestrian
bridge)



DK Senza

TU2B

Shuttle Bus Schedule

SATURDAY & SUNDAY

Route TU3A (Estimated arrival time only. Please be ahead of schedule and wait for the bus.)

Bus stop opposite E-Tiara, Aeon Big and Subang Parade	SS15 LRT Station Gate B Bus Stop	Bus stop at SS15 Maybank / RHB	Bus stop opposite Mentari Court and LCS (can be access from KTM Setia Jaya)	Aman / Ridzuan Apt / Suria Mas and Caltex opposite Sunway Pyramid (near pedestrian bridge)	DK Senza / Lakeside Campus
7.00am	Drop-off / Pickup	Drop-off / Pickup	Drop-off / Pickup	Drop-off / Pickup	Back to E-Tiara
8.00am	Drop-off / Pickup	Drop-off / Pickup	Drop-off / Pickup	Drop-off / Pickup	Back to E-Tiara
9.00am	Drop-off / Pickup	Drop-off / Pickup	Drop-off / Pickup	Drop-off / Pickup	Back to E-Tiara

Route TU3B - Round-Trip (Estimated arrival time only. Please be ahead of schedule and wait for the bus.)

Lakeside Campus	Sunway Pyramid (new wing bus stop)	Bus stop opposite E-Tiara, Aeon Big and Subang Parade	SS15 LRT Station Gate B Bus Stop	Bus stop at SS15 Maybank / RHB	Aman / Ridzuan Apt / Suria Mas, Bus stop opposite Mentari Court and LCS (can be access from KTM Setia Jaya) and Caltex opposite Sunway Pyramid (near pedestrian bridge)	DK Senza
10.15am	Drop-off / Pickup	Drop-off / Pickup	Drop-off / Pickup	Drop-off / Pickup	Drop-off / Pickup	Back to Campus
11.15am	Drop-off / Pickup	Drop-off / Pickup	Drop-off / Pickup	Drop-off / Pickup	Drop-off / Pickup	Back to Campus
12.15pm	Drop-off / Pickup	Drop-off / Pickup	Drop-off / Pickup	Drop-off / Pickup	Drop-off / Pickup	Back to Campus
2.15pm	Drop-off / Pickup	Drop-off / Pickup	Drop-off / Pickup	Drop-off / Pickup	Drop-off / Pickup	Back to Campus
3.15pm	Drop-off / Pickup	Drop-off / Pickup	Drop-off / Pickup	Drop-off / Pickup	Drop-off / Pickup	Back to Campus
4.15pm	Drop-off / Pickup	Drop-off / Pickup	Drop-off / Pickup	Drop-off / Pickup	Drop-off / Pickup	Back to Campus
5.15pm	Drop-off / Pickup	Drop-off / Pickup	Drop-off / Pickup	Drop-off / Pickup	Drop-off / Pickup	Back to Campus
*6.15pm	Drop-off / Pickup	Drop-off / Pickup	Drop-off / Pickup	Drop-off / Pickup	Drop-off / Pickup	Trip ends

* Last trip from Taylor's Lakeside Campus at 6.15pm

Students are advised to be at the bus stop at least 10 minutes before the departure time. If you have any concerns about the shuttle services or experience delays, please contact the bus supervisor at **016-787 3173 (Mr. Peter)** or email to CampusCentral@taylors.edu.my. Please take note that the arrival and departure times are only indicative and may vary due to traffic condition. Bus schedule may be changed without prior notice due to heavy traffic or weather condition.

Shuttle Bus Schedule

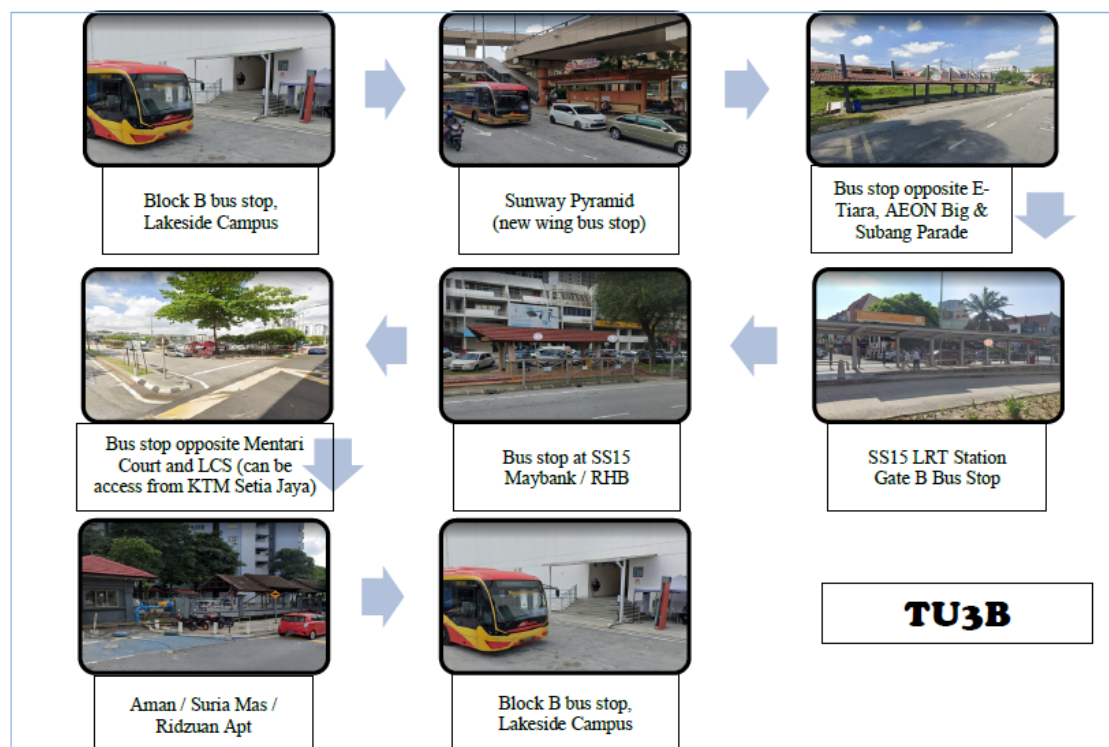
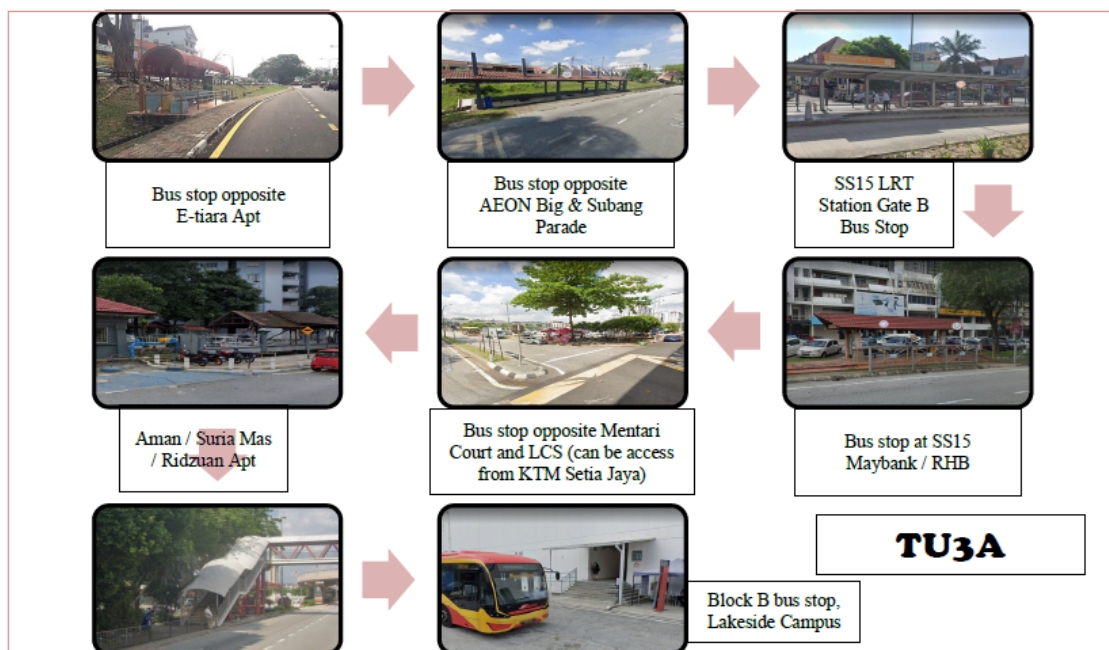

Orientation Programme

WHY I SHOULD ATTEND THE ORIENTATION



SMOOTH TRANSITION

Orientation eases new students' transition and setting into Taylor's education system, and the life and culture at our Lakeside Campus

GAIN FULL ACCESS

Find your way around and gain access to facilities, support services, general amenities and transportation

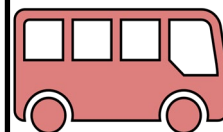

BE INTRODUCED AND GET INVOLVED

There are many activities beyond the classroom on offer at Taylor's to cater to every need

MEET OTHER STUDENTS

Get acquainted with the globalized population on campus



DON'T MISS OUT

Important information, checklist and to-dos when you arrive and throughout the duration of your studies, both from Faculty Offices and Support Services

Orientation FAQ

1. What can I expect from my orientation?

The Orientation is designed to provide you with all the necessary information and support to ensure a successful transition to campus. Get ready to experience an immersive and purposeful Orientation on campus from **21st August to 25th August!** Expect to attend engaging academic briefing sessions, embark on exciting explorer activities to discover the campus, have the opportunity to meet and greet our dedicated staff and student representatives, and participate in enjoyable social activities. Our aim is to ensure that you feel fully prepared, connected, and empowered to make the most of your time at Taylor's.

2. What is the information I would have received before my Orientation?

You will receive the Welcome Email and a link to log in to [Taylor's Orientation Portal](#) on **Wednesday, 12th July 2023**. Kindly refer to the email to understand the breakdown of the task you will need to complete before attending the Orientation. If you have not received any of the above-mentioned email, please email orientation@taylors.edu.my for assistance.

3. I am unable to access Taylor's Orientation Portal. What should I do?

You will only be able to view uploaded content on Taylor's Orientation Portal 48 - 72 hours (2 to 3 working days) after you have accepted the offer to study at Taylor's. Please email to orientation@taylors.edu.my if you are not able to access the portal after 72 hours of receipt of letter of offer acceptance.

4. What should I do if I cannot attend Orientation on Campus?

We understand that some students may be unable to attend the academic briefing in person. Don't worry, we've got you covered. A recording of the academic briefing will be made available for you. Look for the Timetable tab in [Taylor's Orientation Portal](#) three (3) working days after your Orientation, and you'll find the link to access the recordings there.

5. What should I do if I miss Orientation or enrol after 21st August 2023?

If you missed the scheduled Orientation or enrol after your Orientation Day, kindly refer to the Info Sheet provided [HERE](#) to ensure you are up to date with the necessary steps before commencing your classes.

6. Whom do I contact if I have inquiries about the Orientation?

Drop us your Orientation inquiries at orientation@taylors.edu.my

If you have any enquiries **unrelated** to Orientation, please submit an [Online Enquiry](#) on Campus Central Portal. You may also use the Live Chat function on the portal or the Mobile app to chat with us.

Taylor's University

Student Council

TUSC serves as the chief representative body for students in the institution, with representation from all the schools. They serve as key intermediary between the University and students on non-academic welfare issues and resolution, spearhead enriching initiatives to integrate students across all Schools and represent Taylor's University for inter-varsities collaborations, networking avenues and efforts of the Ministry of Education Malaysia. Elections are held annually to elect students for its various office-bearer positions as well as positions on the governing council. The TUSC can be contacted at tusc@taylors.edu.my

TAYLOR'S UNIVERSITY STUDENT COUNCIL 22/23 EXECUTIVE COMMITTEE



Suleman Mir
PRESIDENT
suleman.tusc@gmail.com



Elisha Paulraj
VICE PRESIDENT
elishapaulraj.tusc@gmail.com



Stephanie Goldwyn
SECRETARY
stephaniegoldwyn.tusc@gmail.com



Yong Tung Joe
TREASURER
yongtungjoe.tusc@gmail.com

Taylor's University

Student Council

TAYLOR'S UNIVERSITY STUDENT COUNCIL 22/23 BOARD OF DIRECTORS

CAMPUS INTEGRATION



Faiqah Feroze
DIRECTOR
faiqahferoze.tusc@gmail.com



Ludwina Rumuat
ASSISTANT DIRECTOR
ludwinarumuat.tusc@gmail.com

CAMPUS RELATIONS



Dennisa Louis Tjonkawijana
DIRECTOR
dennisalouistjonkawijana.tusc@gmail.com



Faustine Lanie Santoso
ASSISTANT DIRECTOR
faustinelanie.tusc@gmail.com

CAMPUS WELFARE



Liew Zhan Leong (Kayden)
DIRECTOR
kaydenliew.tusc@gmail.com



Tan Yie Sin
ASSISTANT DIRECTOR
tanyiesin.tusc@gmail.com

Campus Floor Plan

1ST FLOOR

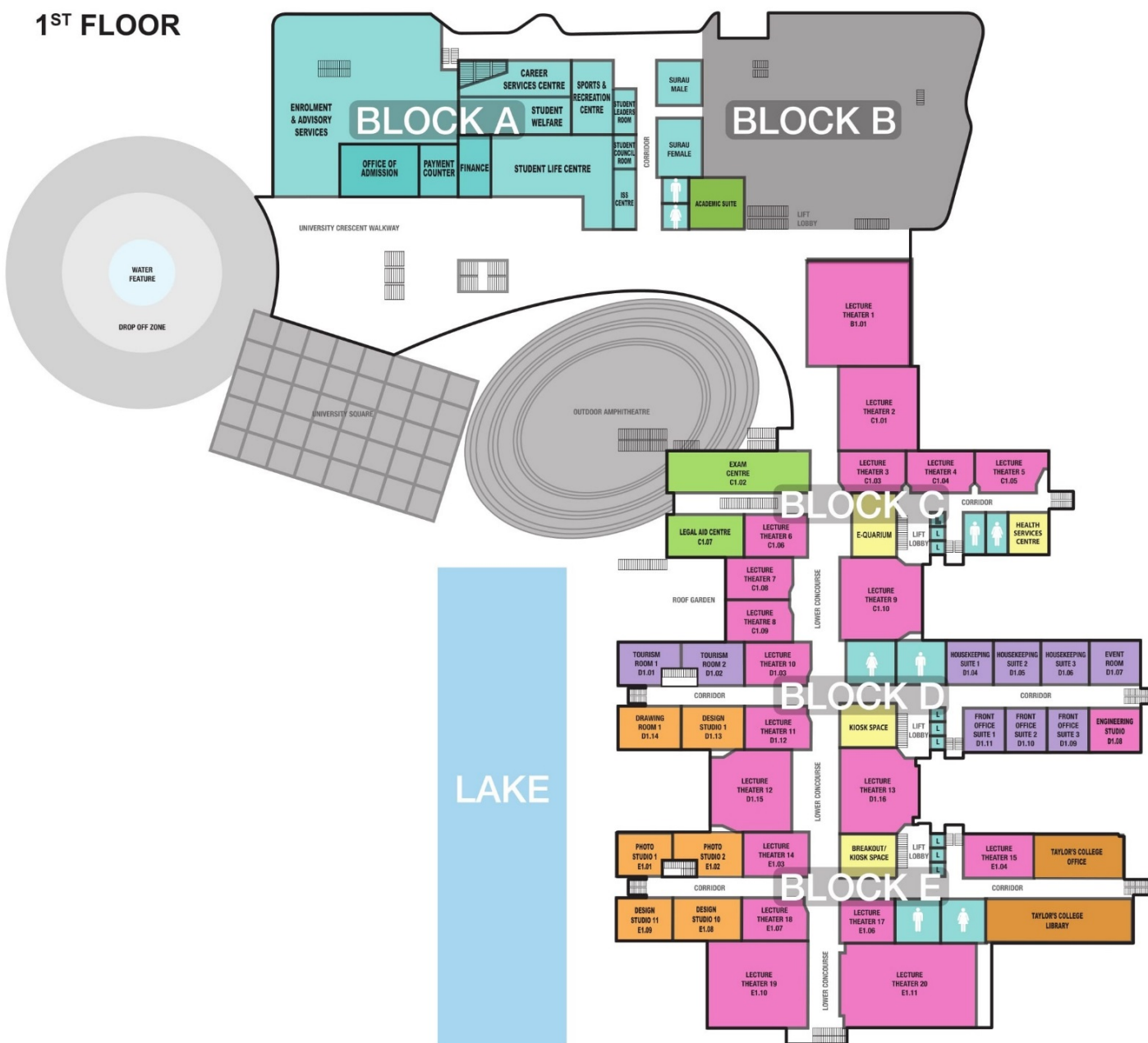

Campus Floor Plan

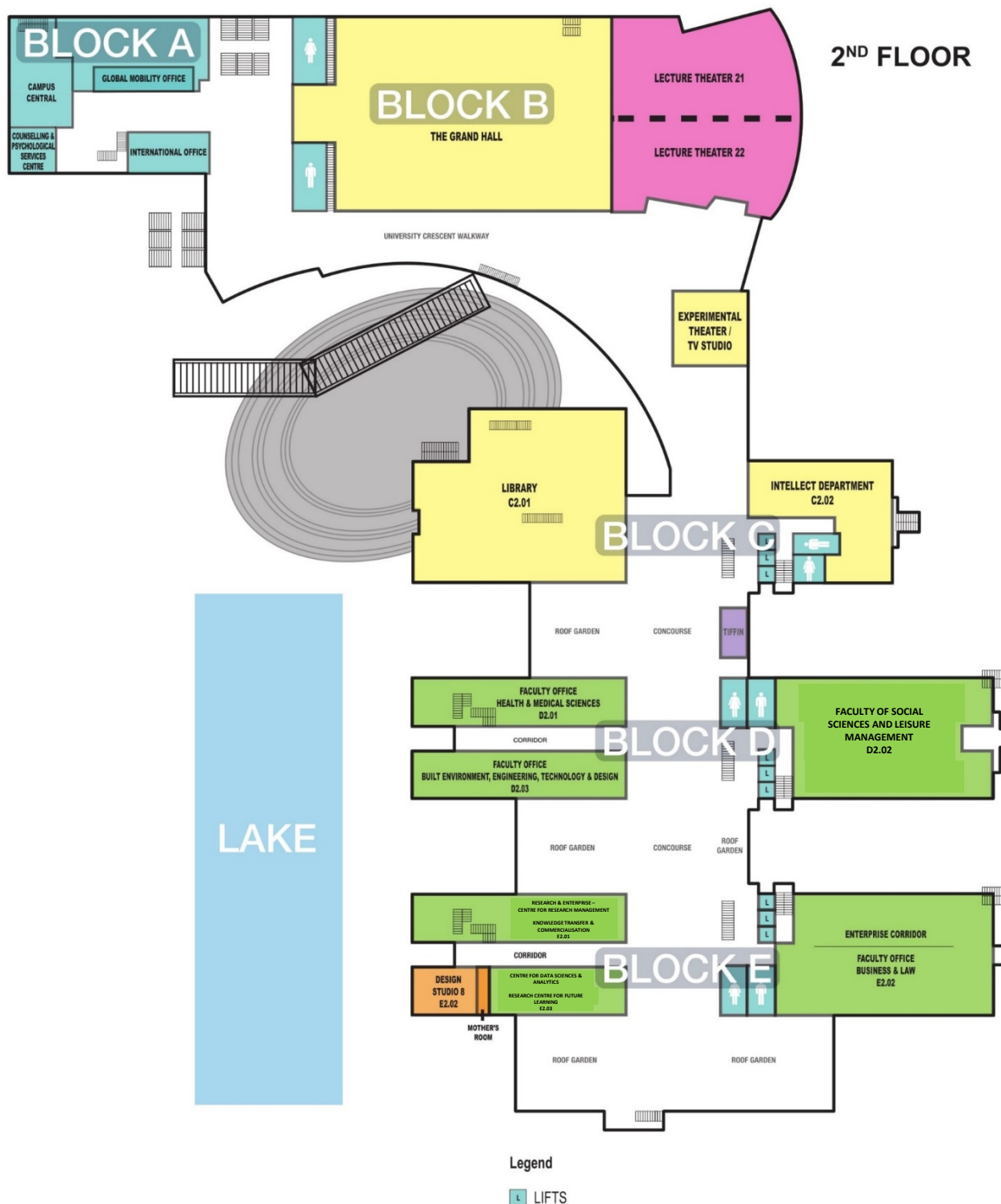



**TAYLOR'S
UNIVERSITY**

Wisdom • Integrity • Excellence

Taylor's Lakeside Campus

No.1, Jalan Taylor's, 47500 Subang Jaya, Selangor Darul Ehsan

Tel : 603-5629 5000

Email : campuscentral@taylors.edu.my

Website : www.taylors.edu.my

This publication contains information which is current as of 14 July 2023. Changes in circumstances after this date may impact upon the accuracy or timeliness of the information. Taylor's does its best to ensure that the information contained herein is accurate but reserves the right to change any information described in this guide without notice. Readers are responsible for verifying information that pertains to them by contacting the university.